

irisCONNECT

Record Kit



Recording Device/s
(Stored in case lid)



Bluetooth
Microphone



Mic Stand



Mini Tripod



Floor Tripod
(Stored outside of the case)



Charger



Coaching Ear-piece
(Used with Go Live feature)



The tripod can be attached to
the case using the bungee cords
and metal rings

	Kit Type	Included or BYOD: Devices and charging cables	Bluetooth Microphones (and charging cables)	Mic Stands	Mini Tripod	Floor Tripod	Charger	Coaching Ear Piece
Record Kit <i>Basic</i>	Single (Single View, Single Mic*)	1	1	1	1	x	2 Port	Included with the Go-Live feature
Record Kit <i>Standard</i>	Single (Single View, Single Mic*)	1	1	1	1	1	2 Port	
Record Kit <i>DualView</i>	Dual (Dual View, Single Mics*)	2	2	2	1	1	4 Port	

*Pro versions (2 microphones per device) also available for each Kit Type... Basic Pro, Standard Pro, DualView Pro.

Support Hub

For set-up instructions, user guides and device specifications & compliance scan the QR code or go to help.irisconnect.com

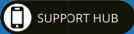

Contact Details

Phone:
UK/EU +44 (0) 333 136 2483
US +1 206 201 1998
Online chat: help.irisconnect.com
Email: support@irisconnect.com

Kit Type:

Base Kit

(Same as Basic above but no charger included)

Serial Number

See the reverse side for tripod and microphone setup and recording instructions



1. Recording Devices

Decide if you want to make a single or dual recording
Devices are stored in the lid. If one is not included in the kit you will need to provide your own
The device/s need the IRIS Connect Record app installed and sufficient charge and storage space



2. Stand Setup

Always place the recording device in a landscape orientation into the holder
Make sure the device is held securely in the holder before moving the tripod



A: Mini Tripod

Press the buttons on the legs to extend to the desired height
Use the lower, adjustable ring to change how wide the legs can extend
Use the higher, adjustable ring to change the angle of the holder
If you are using a tablet, use the buttons on the back of the holder to extend the holder so the device is held securely



B: Tripod

Loosen the screw and pull out all the legs to unclip them
Pull the legs down to the desired distance then tighten the screw
(the wider the legs are extended the greater stability the tripod will have)
Open the clips to extend the central pole, then close at the desired height
For larger devices, rotate the holder to a portrait orientation, and place the tablet in the holder in a landscape orientation.
For smaller devices rotate the holder so it is in a landscape orientation

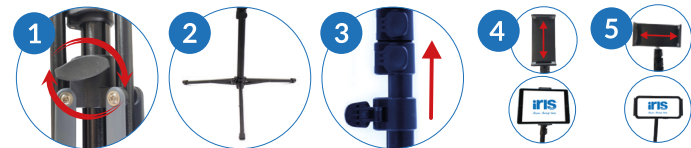

3. Connecting To The Microphone

If you have previously paired your device to the microphone, follow the steps below

Decide how many microphones you want to use. You can use 2 per device
Make sure Bluetooth is turned on on your device/s
Press and hold the microphone button for 3 seconds to turn the microphone on
The microphone will automatically connect and show a blue flash every 5 seconds
The device will now show **IRIS Connect Microphone** as 'Connected' on the Bluetooth menu

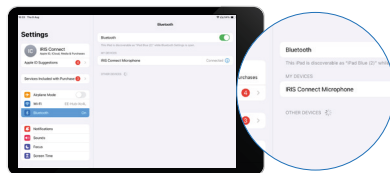

If the microphone hasn't paired, you may need to follow the [Pairing the microphone guide](#) on the right



4. Recording

Place the tripod/stand either on the floor, desk or shelf
If you are using the ProStand and it is placed somewhere where it might get knocked or if it's extended quite high, we recommend using the velcro strap included in the kit to secure it to a table leg or similar

Clip the microphone to your clothing or use the lanyard provided.
Place other microphones in the stands
Launch the IRIS Connect Record app on your device/s and follow the on-screen instructions



5. After Recording

Make sure your recording has completed uploading before closing the Record app
Power off then charge the microphone and device/s before returning them to the case (to turn off the microphone, press the button for 3 seconds until you see a purple light, then release)

Pairing The Microphone

When pairing for the first time make sure the distance between the device and microphone is less than 1 metre

Turn on the microphone by pressing and holding the button for 3 seconds until the indicator light shows a purple light, then release

Navigate to your device's Bluetooth settings menu

Turn on Bluetooth and select **IRIS Connect Microphone** from the list of available Bluetooth devices

The device will now show the status as 'Connected' on the Bluetooth menu

Indicator Light Guide

- Blue flashing - pairing mode
- Blue flash every 5 seconds - paired

- Solid Purple - powering on/off
- Solid red - low battery

Charging

- Solid red - charging
- Solid green - fully charged

iris **CONNECT**